

Sponsor: L&T, Chennai

- Precast concrete structural walled buildings made of Precast Large Concrete Panels (PLCP) - No Columns and Beams, Only PLCPs joined together
- Overall structural behaviour depends on connection between individual PLCP
- Seismic performance of these connections (*wall-wall horizontal, wall-wall vertical and slab-wall*) between PLCP are studied experimentally at CSIR-SERC
- Cyclic load tests conducted on 10 specimens

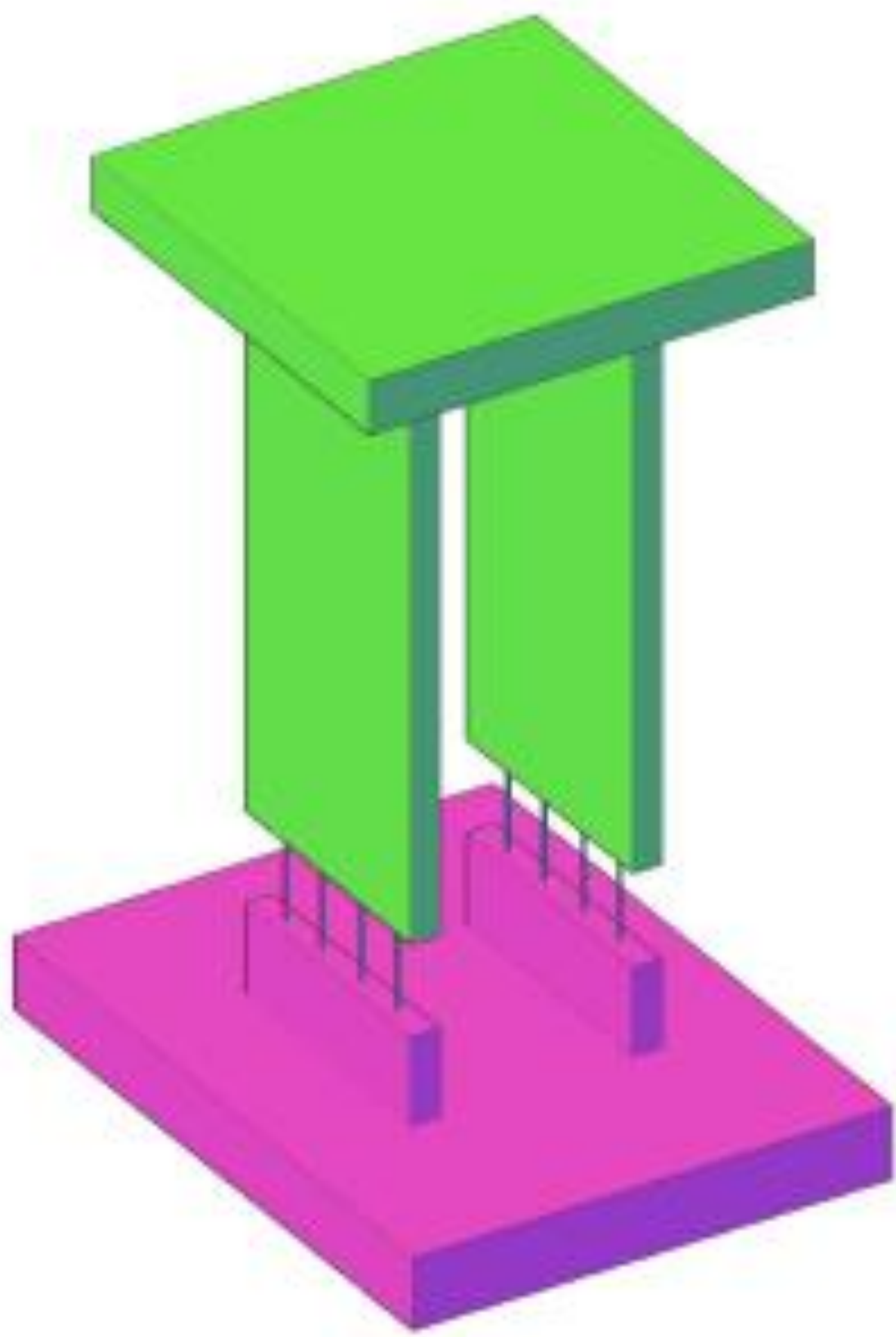

*Wall-wall horizontal connection (Slender wall)*

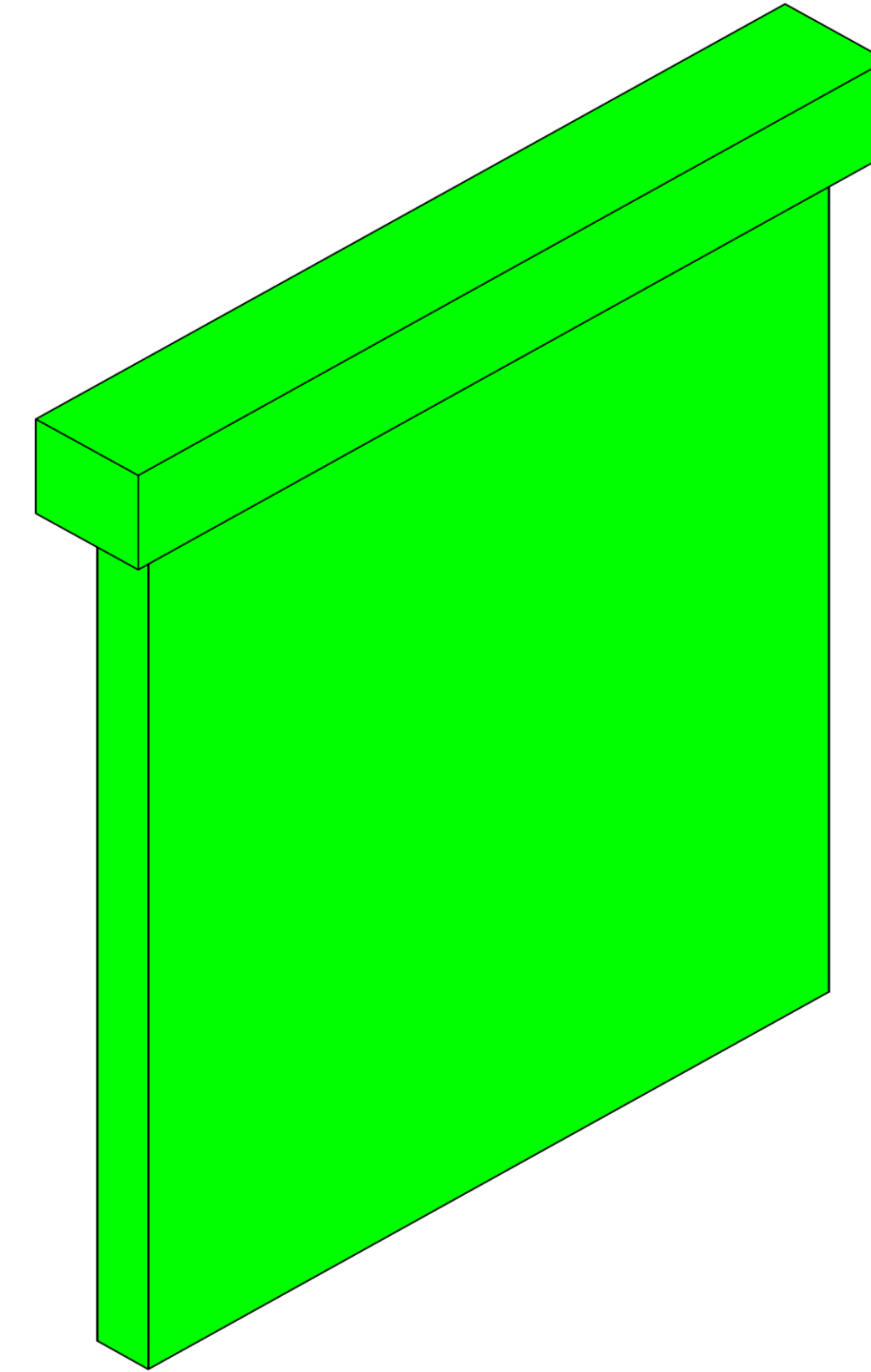

WALL WITH BEAM ELEMENT (EL-2)

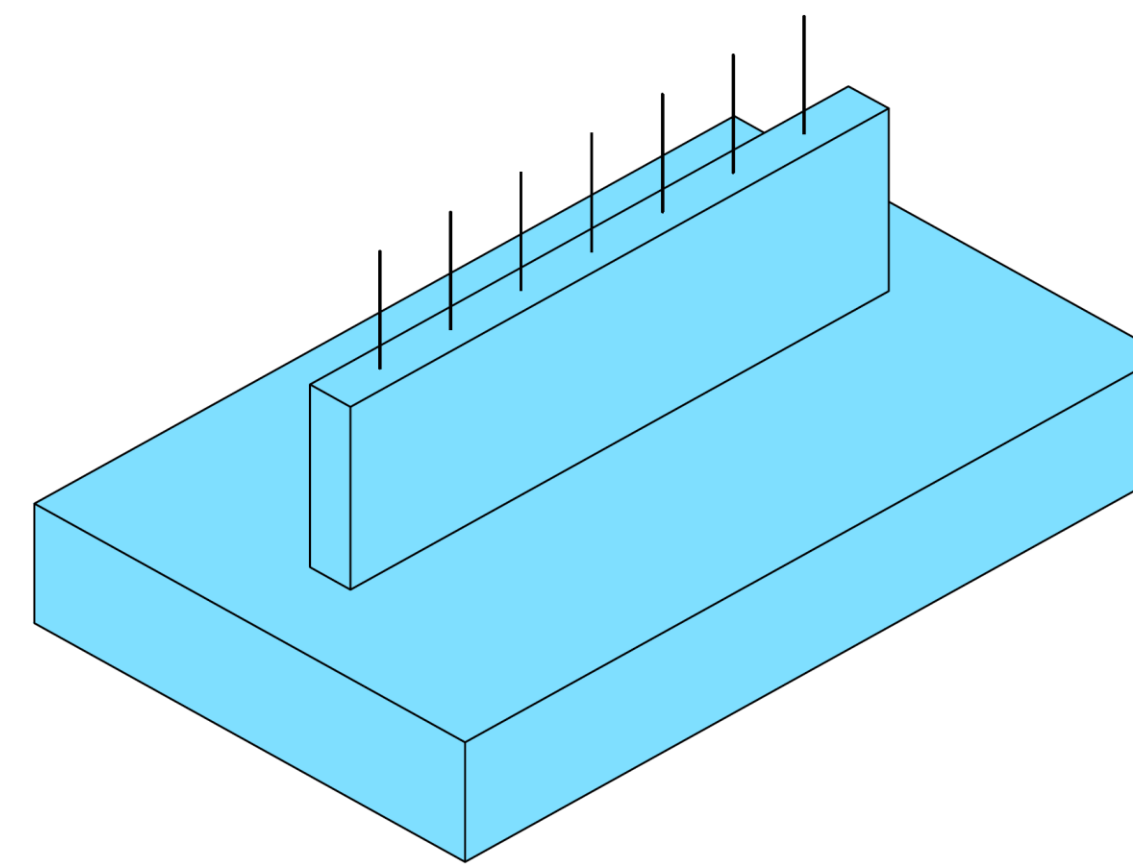

BOTTOM SLAB ELEMENT (EL-1)



*Wall-wall horizontal connection (Squat wall)*

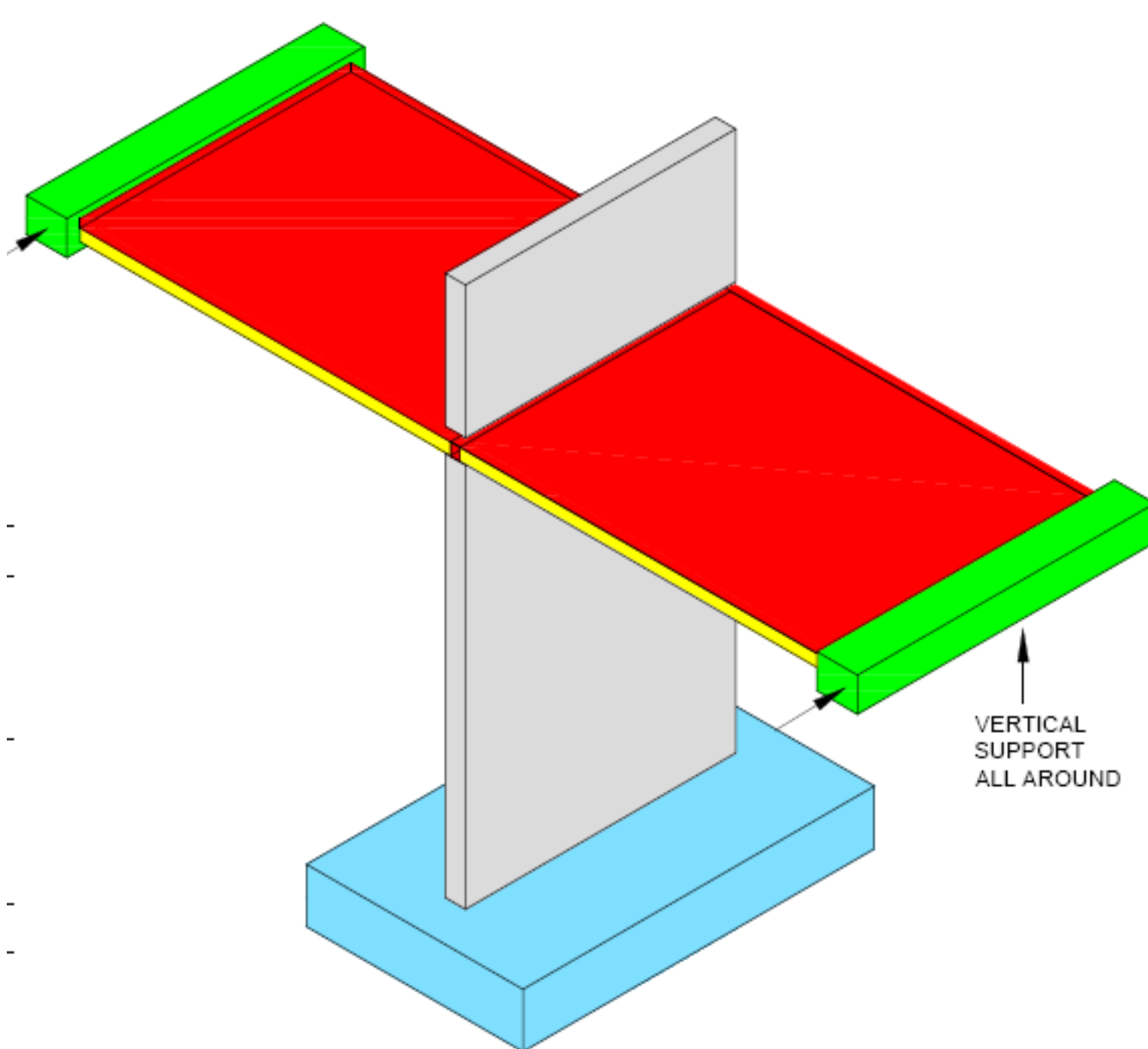

ISOMETRIC VIEW OF TEST SPECIMEN



*Wall-slab connection*

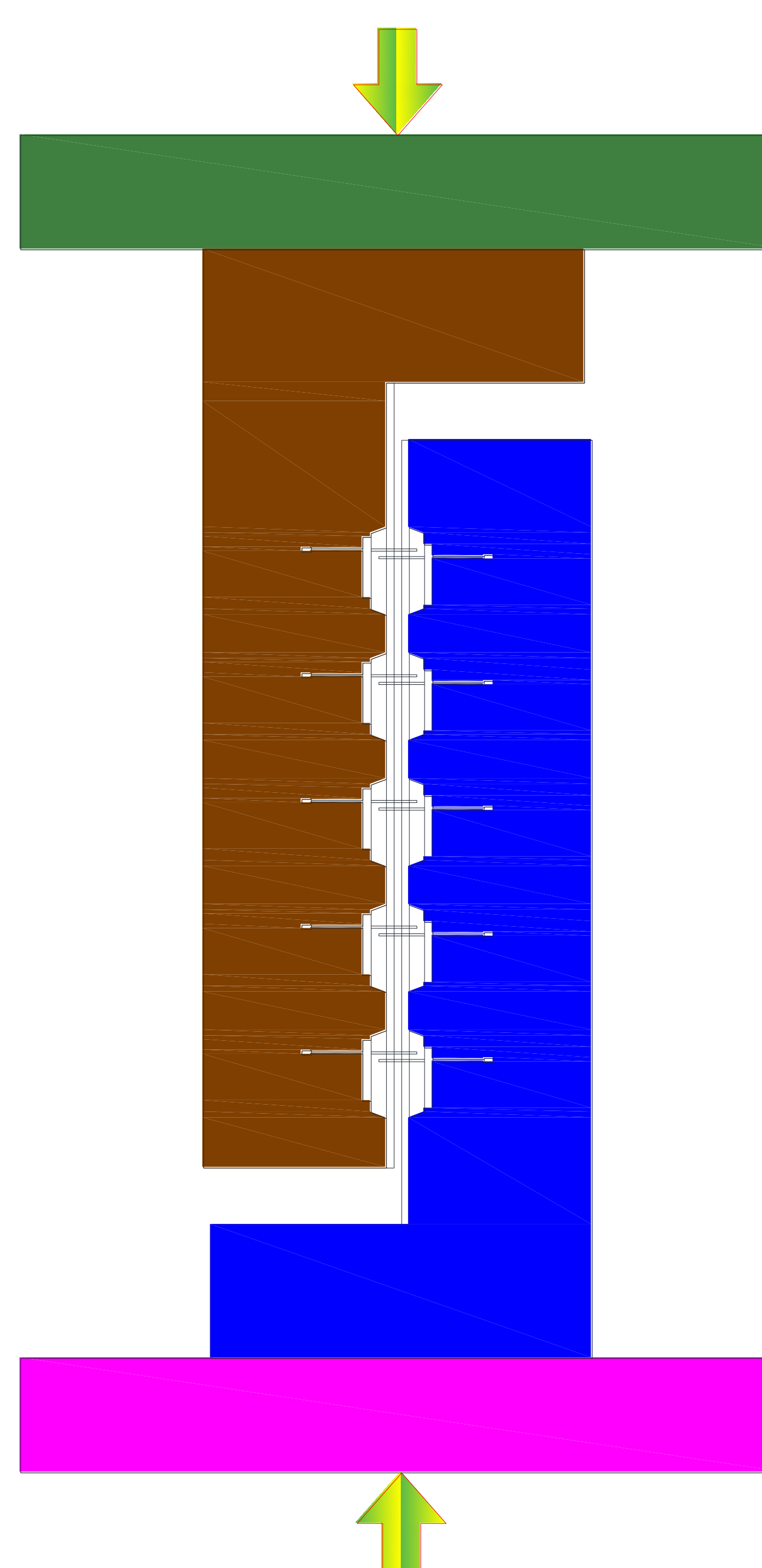

*Wall-wall vertical connection*